

# SMART-IN10 A/Z

## RECESSED PROFILE PROFIL WPUSTOWY

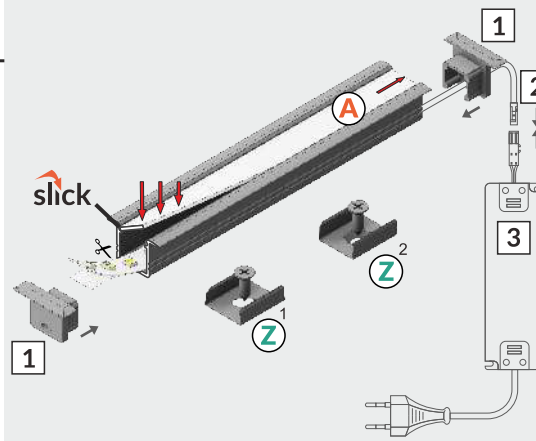
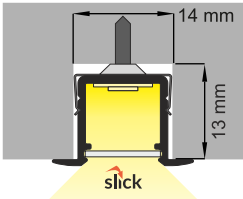
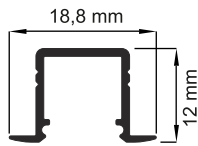

- A** A slide cover klosz A wsuwany
- Z<sup>1</sup>** Z flexible mounting plate uchwyt Z sprężysty
- Z<sup>2</sup>** cone Z flexible mounting plate uchwyt Z sprężysty cone

- 1** SMART-IN10 ending with hole zaślepka SMART-IN10 z otworem
- 2** power supply cable kabel zasilania
- 3** LED power supply zasilacz LED



scissors  
nożyczki



pliers  
kombinerki



soldering iron  
lutownica



solder  
cyna



glue  
klej

I

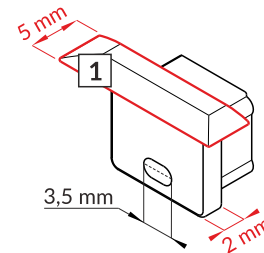
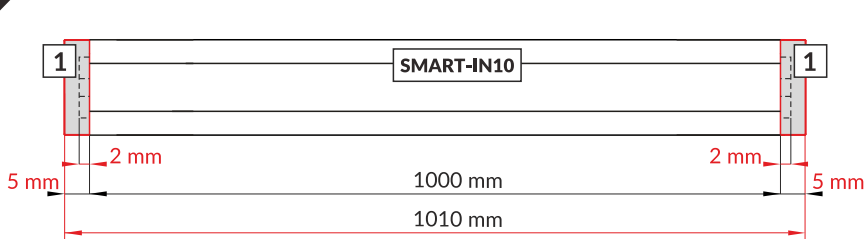

**Note!** Ending thickness increases the length of the luminaire (+ 2 x 5 mm) and the length of the mounting space (+ 2 x 2 mm).  
**Uwaga!** Grubość zaślepki zwiększa długość oprawy (+ 2 x 5 mm) i długość otworu montażowego (+ 2 x 2 mm).

II

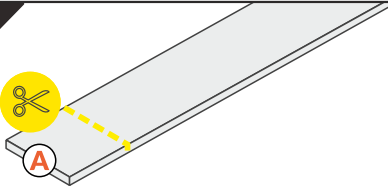

The length of the cover is equal to the length of the profile.  
Długość klosza równa jest długości profilu.

III

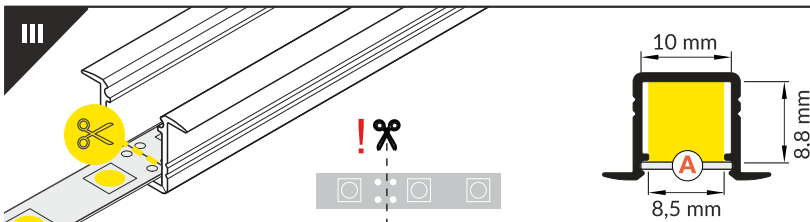

Dimensions of the space to install LED source.  
Wymiary przestrzeni do zamontowania źródła LED.

IV

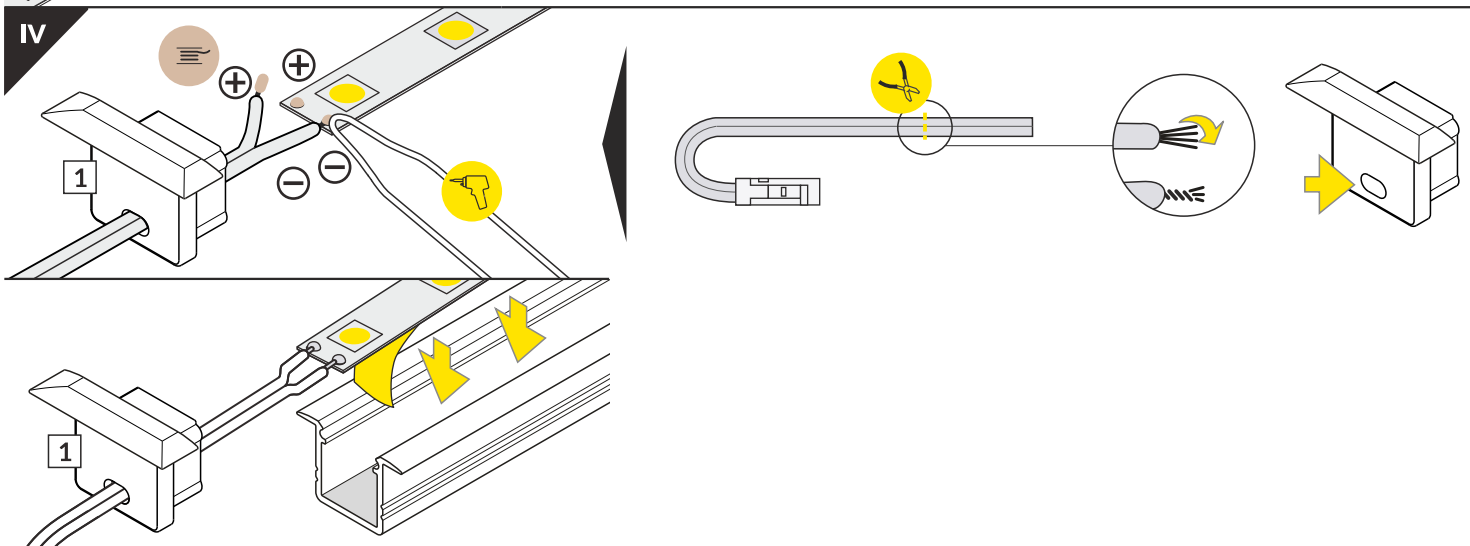

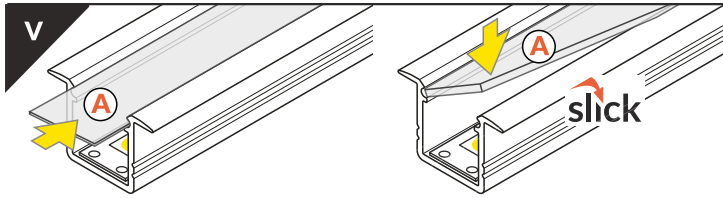

**A** slide cover / klosz **A** wsuwany

## VI MOUNTING / MONTÁŽ

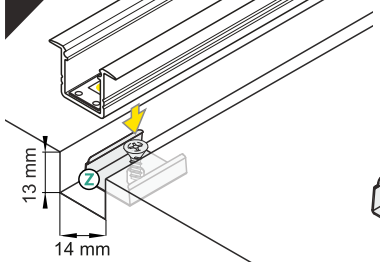

**Z** flexible mounting plate  
uchwyt **Z** sprężysty

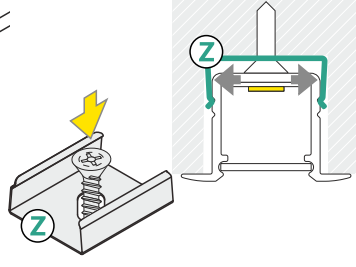

**Z** flexible mounting plate  
uchwyt **Z** sprężysty

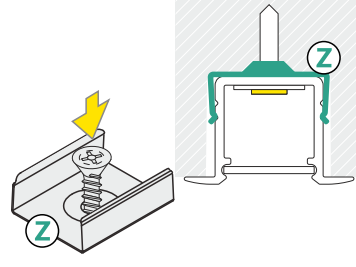

cone **Z** flexible mounting plate  
uchwyt **Z** sprężysty cone

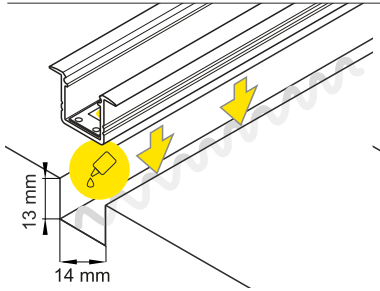

glue  
klej montażowy

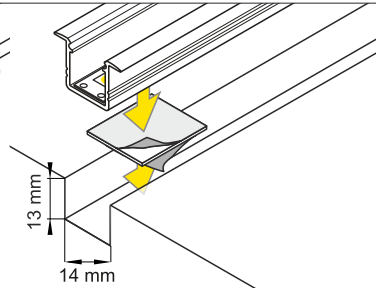

two-sided adhesive tape 25x25  
taśma mocująca dwustronna 25x25

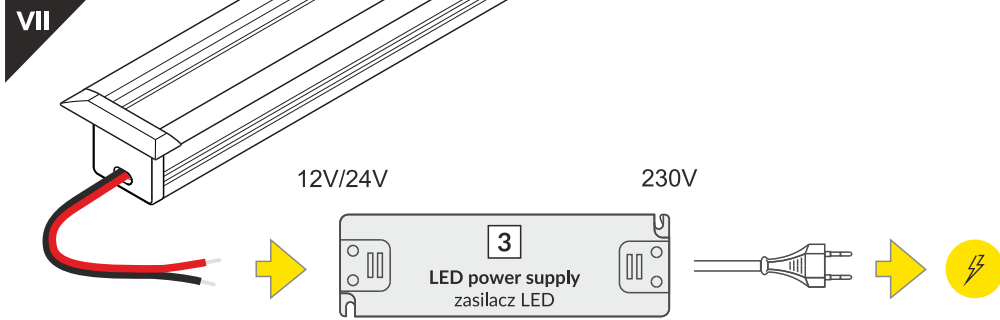

## ACCESSORIES / AKCESORIA

- power switches
- controller + remote
- movement sensors

Hungarian distributor



[www.s-lightled.hu](http://www.s-lightled.hu) | [www.topmet.com](http://www.topmet.com)

